

**VS**  
SASSOON

**FOR MEN**



**THECRAFTEDMAN**

# TOOL TIPS

for the rechargeable hair & beard clipper  
with accessories + travel bag.

VSM750A

**HEY YOU!**  
**TAKE A BOW FINE SIR.**

---

THINGS ARE LOOKING UP  
& **YOU'VE JUST MADE A  
QUALITY PURCHASE**  
WITH THIS NEW GROOMING TOOL.

---

WE KNOW YOU'VE GOT THIS, BUT BEFORE YOU JUMP INTO  
USING YOUR NEW SIDE KICK, HERE'S A FEW TIPS & TRICKS  
TO KNOW BEFORE LETTING YOUR CREATIVITY RUN LOOSE.

---

HIT UP [VSFORMEN.COM.AU](http://VSFORMEN.COM.AU) FOR MORE GROOMING & INSPIRATION.



# IMPORTANT SAFETY INSTRUCTIONS

When using electrical appliances, especially when children are present, basic safety instructions should always be followed, including the following:

Polythene bags over product or package may be dangerous. To avoid danger of suffocation, keep this wrapper away from babies and children. This bag is not a toy.

**DANGER:** When the unit is used in a bathroom, unplug it after use since the proximity of water presents a hazard even when the appliance is switched off.



**WARNING:** Do not use or leave the AC power adaptor in a position where it can become wet or there is a danger of it falling into a basin or other vessels containing water. Keep the appliance dry, unless it otherwise specified. Do not use this appliance in or near bathtubs, showers, basins or other vessels containing water.

- Do not immerse appliance in water or other liquids.
- Do not reach for an appliance that has fallen into water.
- Take care to avoid contact between the moving blades of the unit and the skin, paying particular attention to the face, neck and hands.
- This appliance is not intended for use by persons (including children) with reduced physical, sensory or mental capabilities, or lack of experience and knowledge, unless they have been given supervision or instruction concerning use of the appliance by a person responsible for their safety.
- Children should be supervised to ensure that they do not play with the appliance.

**IMPORTANT:** Always ensure the appliance is switched off when not in use or before cleaning. Do not leave unattended when switched on. Do not place on any heat sensitive surface.

- Do not use any attachments other than those supplied by Conair Australia Pty Ltd.
- Use this appliance only for its intended use as described within this instruction booklet.
- Always unplug the appliance when fully charged.
- This appliance is not intended for commercial use.
- Never drop or insert any object into an opening.
- Do not use the appliance with damaged or broken attachment combs or with any teeth missing from the blades, as injury may occur.
- Do not place on any surface while it is operating.
- Keep the cord away from heated surfaces
- Never twist or pull on the power cord.
- Do not use an extension cord with this appliance.
- After use do not wrap the cord around the appliance as in time this may cause the cord to fracture. Coil cord loosely by the side of the appliance in storage.
- Do not use outdoors or operate where aerosol (spray) products are being used or where oxygen is being administered.
- Do not use the appliance if it is damaged. In the event of damage, discontinue use immediately and contact your dealer for instructions on returning it for examination or exchange. If the supply cord is damaged, it must be replaced by the manufacturer, its service agent or similarly qualified person in order to avoid a hazard.
- Always ensure that the voltage to be used corresponds to the voltage marked on the unit.
- For additional protection, the installation of a residual current device (RCD) with a rated operating current not exceeding 30mA is advisable in the electrical current circuit supplying the bathroom. Ask your installer for advice.

# THE CRAFTED MAN

**BRAVO. YOU'VE MADE A QUALITY PURCHASE.**

The Crafted Man is the rechargeable hair & beard clipper with accessories + travel bag.



- |                                                           |                                                                                                    |                                                |
|-----------------------------------------------------------|----------------------------------------------------------------------------------------------------|------------------------------------------------|
| 1. Cordless use                                           | 7. Easy to read lateral display of selected cutting length                                         | 11. Smart shape stands freely on your benchtop |
| 2. Precision W-Tech blades                                | 8. 3mm to 18mm hair cutting comb guide                                                             | 12. Travel bag                                 |
| 3. 40mm clipping blade                                    | 9. 21mm to 36mm hair cutting comb guide                                                            | 13. Barber comb                                |
| 4. Smart Adjusting System™                                | 10. 1x 5 position precision comb guide (0.5mm to 4.5mm) for trimming stubble or short beard styles | 14. Cleaning brush                             |
| 5. Washable, removable blades for easy cleaning           |                                                                                                    | 15. Oil                                        |
| 6. Integrated dial adjusts trimming settings in 1mm steps |                                                                                                    |                                                |

# PREPPING YOUR NEW TOOL

## CHARGING

The Crafted Man Clipper hair and beard clipper is so easy to use. But before you start using your new tool, you must take the time to charge it overnight for **16 hours** before its first use. Your new tool comes with a small amount of charge, but the initial charge will ensure your new tool will have optimum power performance to give you smooth fast cutting, every time.

- Before using for the first time, fully charge your new tool continuously for 16 hours.
- Maximum battery capacity will only be reached after 3 charging & discharging cycles.
- Ensure your new tool is switched off.
- Insert the small plug on the charging adaptor into the socket on the bottom of your new tool.
- Plug the charging adaptor into a suitable mains power socket and switch on.
- The charging LED indicator light on your new tool will remain on when correctly connected to the mains power.
- After the first 3 full charges of 16 hours, all subsequent charges should be 8 hours.
- A full charge of 8 hours will supply 45 minutes cordless runtime.

**IMPORTANT NOTE - NEVER CHARGE THE CLIPPER FOR PERIODS LONGER THAN 24 CONSECUTIVE HOURS AND ONLY USE THE CHARGING ADAPTOR PROVIDED.**

# HOW TO USE THE CRAFTED MAN CLIPPER

## BEFORE USING

- Always inspect the clipper blades for noticeable signs of damage.
- Ensure the clipper blades are well oiled before using.
- Always inspect the clipper blades before use to ensure they are free from hair, debris etc.
- Ensure the clipper is sufficiently charged before use.
- For best performance use on clean, dry hair that has been combed until tangle-free.



## CLIPPING FOR ALL HAIR LENGTHS

The Crafted Man features 2x hair cutting comb guides (3mm to 18mm + 21mm to 36mm) with 32 positions for short or longer hair clipping.

1. Use the 3mm to 18mm comb guide for cutting short hair lengths
2. Use the 21mm to 36mm comb guide for cutting longer hair lengths, and pre-trimming down hair from longer lengths.

To attach the cutting guide, firstly position the control wheel of the clipper to the mark "3" on the side display.

- To attach a comb guide, ensure the appliance is switched off. Position the comb guide over the front of the clipper blade and slide over the head. Push and click the rear of the comb guide into position (Fig.1)
- To remove the comb guide, ensure the appliance is switched off. Push the tab on the rear of the comb guide away from the head and lift off (Fig.2)

Fig. 1

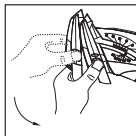
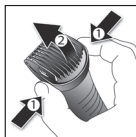

Fig. 2



## SELECTING THE CUTTING LENGTH

To adjust the clipper's cutting length, turn the dial up or down.

The selected cutting length is displayed on the right or left side of the clipper, depending on the comb guide attached.

LEFT SIDE – 3mm to 18mm cutting lengths, use the shorter comb guide

RIGHT SIDE – 21mm to 36mm cutting lengths, use the longer comb guide

## SMART ADJUSTING SYSTEM™

The Smart Adjusting System ensures the length of the cut stays exactly the same, regardless of the cutting angle. Cut as high as 75°C or as low as 35° & always achieve precision results.

# CLIPPING TIPS

Hit up [www.vsformen.com.au](http://www.vsformen.com.au) for more grooming tips, inspiration & guidance on how to get the best use of your clipper.

## CREATING AN ALL-OVER EVEN CUT

1. Ensure the clipper is switched off.
2. Attach the desired cutting comb guide and select the desired cutting length as required.
3. Switch the clipper on – the blades will start to move.
4. Start cutting at the nape of the neck, holding the clipper with the teeth of the clipper pointing upwards, ensuring that the comb guide is resting flat against the head.
5. Slowly move the clipper upwards and outwards through the hair towards your crown, against the direction of the hair growth. The comb guide will help to lift the hair and the blades will cut the hair to the length as shown on the comb guide.
6. Once the desired length is achieved at the back of the hair, start clipping the top and sides.
7. Hold the clipper to the front of your hair with the teeth pointing towards the back of your head, and move the clipper towards your crown. Repeat as necessary, moving in rows from the front and the sides of your head to the back.

## **CREATING A SHORT BACK & SIDES LOOK, WITH LENGTH ON THE TOP**

1. Ensure the clipper is switched off.
2. Attach the desired cutting comb guide and select the desired cutting length as required.
3. Switch the clipper on – the blades will start to move.
4. Hold the clipper to the front of your hair with the teeth pointing towards the back of your head and move the clipper towards your crown. Repeat as necessary, moving in rows from the front and the sides of your head to the back.
5. If you then wish to take the back and sides of your hair to a shorter length, switch off the appliance and attach the shorter comb guide.
6. Start cutting at the nape of the neck, and with the comb guide flat against the head, move the clipper upwards and outwards over the area you want to take shorter.
7. Repeat on the sides of the hair, starting with the teeth of the clipper pointing upwards and comb guide flat against the area above the ear, again moving the clipper upwards and outwards.

## OUTLINING

1. To tidy up the edges around your cut e.g. neckline and sideburns, detach the comb guides.
2. Hold the clipper upside down, so the front of the clipper is facing towards your head.
3. Hold the clipper straight on your sideburns or neckline and move the clipper downwards. This will give you a clean, smooth finish.

## BEARD MASTERY MADE EASY

The Crafted Man also includes a 5 position precision comb guide (0.5mm to 4.5mm) for trimming stubble or short beard styles.

# TRIMMING TIPS

## TRIMMING YOUR NECKLINE

- Hold the clipper with the teeth of the clipper pointing upwards, yet flat against the skin.
- Attach the 5 position comb guide and select the desired cutting length setting.
- Move the clipper upward and outward through the hair, against the direction of hair growth.
- The clipper will work most efficiently when cutting through hair at its own speed. Never force the trimmer.
- Never switch the appliance off whilst in the hair.



## TRIMMING YOUR SIDEBURNS

- Attach the 5 position comb guide and select the desired cutting length setting.
- Always trim your sideburns from the top down.



## TRIMMING & OUTLINING STUBBLE/BEARD

- Attach the 5 position comb guide and select the desired cutting length setting.
- After you have combed through your beard in the direction it grows naturally, you will want to outline the desired shape, beginning under your jawline.
- Begin defining your beard's shape under your chin and work upward on each side of your face toward your ears. Then define the upper outline of your beard across your cheeks, past your sideburns and towards your hairline.



# CLIPPER CLEANING & MAINTENANCE

Because the clipper blades are precision made for a very special use, they should always be handled with care. To ensure long-lasting performance of your clipper, it is important to clean the blades + the comb guides after every use.

## OILING THE BLADES

The blades of your clipper have a reservoir pad that dispenses the amount of oil necessary for your clipper to operate properly, every time. It is nevertheless recommended that you occasionally refill, when you notice the clipper isn't performing as well.

1. Make sure the clipper is switched off and disconnected from the mains  
Remove the clipper blades as described below.
2. Using the oil supplied with your new tool, unscrew the cap & cut off the very end of the plastic tube with a pair of scissors to release the oil.
3. Carefully squeeze a few drops of oil onto the pad (Fig. 3)
4. Then put the blades back onto the clipper, following the instructions below.

**NOTE:** Do not attempt to repair or replace the blades. In the event that the blades become blunt or damaged, contact the Conair Customer Care Line (Conair Customer Service).

## REMOVING THE BLADES

1. Make sure the clipper is switched off and disconnected from the mains.
2. Hold the clipper with the blades pointing up, then remove them by pressing the top of the blade. (Fig. 4)
3. Brush the blades using the cleaning brush to remove any hair.
4. Rinse clipper blades under water to help clear any extra hair or debris that has built up on the blades.

**NEVER IMMERSE THE CLIPPER IN WATER.**

Fig. 3

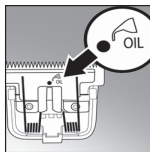
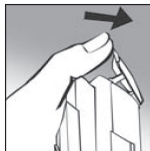







Fig. 4



# WORLDWIDE VOLTAGE

This appliance has a multi voltage feature for worldwide use. The voltage automatically converts for ease of use from 100v - 240v. This appliance has an automatic internal converter which will automatically convert the voltage without the need of a switch. A suitable plug adaptor will be required, please refer to the chart below.

Plug adaptor required	Voltage and plug adaptors	Country	Voltage setting
	British plug: 240V	Ireland, Great Britain, Singapore, South America, Hong Kong (parts only), Africa (parts only)	240V
	European plug: 240V	Asia, Europe, Middle East Noumea, Scandinavia, South America, Hong Kong (parts only)	240V
	Australian and New Zealand plug: 240V	Australia, New Zealand	240V
 	American plugs: 120V	North America, Japan, Canada (parts of)	120V

# BATTERY DISPOSAL

The Crafted Man contains a Nickel Metal-Hydride battery. To protect the environment, the appliance must be disposed of safely at the end of its useful life.



NI-MH

Please take the appliance to a recycling centre, where the internal rechargeable battery should be removed by a professional and recycled separately.

For more information about the recycling of electrical and battery operated appliances, please contact your local council office or your household waste disposal service.



# LIMITED TWO YEAR WARRANTY

Our goods come with guarantees that cannot be excluded under the Australian Consumer Law.

You are entitled to a replacement or refund for a major failure and for compensation for any other reasonably foreseeable loss or damage. You are also entitled to have the goods repaired or replaced if the goods fail to be of acceptable quality and the failure does not amount to a major failure. In New Zealand our goods come with a guarantee that cannot be excluded under the Consumer Guarantee Act 1993.

Conair Australia Pty Ltd. will repair or replace (at our option) your appliance free of charge for twenty-four months from the date of purchase if the appliance is defective in workmanship or materials.

This warranty is an additional benefit and does not affect your legal rights. To obtain service under this warranty, please read the Warranty Leaflet included or contact Conair Customer Service at [aus\\_info@conair.com](mailto:aus_info@conair.com).

---

**TO MAKE A WARRANTY CLAIM YOU MUST  
RETAIN YOUR PROOF OF PURCHASE.**





Vidal Sassoon and related logos are trademarks of  
The Procter & Gamble Company used under license by Conair.

©2017 Conair Australia Pty. Ltd.  
Suite 101, 18 Rodborough Rd  
Frenchs Forest NSW 2086  
Australia

Conair New Zealand Limited  
PO BOX 251159  
Pakuranga, Auckland 1706  
New Zealand

## CONTACT US

For advice & tips on your new VS product email us on:  
[aus\\_info@conair.com](mailto:aus_info@conair.com)

## CUSTOMER SERVICE

Australia: 1800 650 263  
New Zealand: 0800 266 247

Visit [VSFORMEN.COM.AU](http://VSFORMEN.COM.AU) for grooming tips & inspiration.

**VS**  
SASSOON

**FOR MEN**

**YOU WERE  
BORN TO  
BE REAL,  
NOT TO BE  
PERFECT**

IB-17/172